

SPO3000 SERIES



NEW

Features

- Dual / Four channels, 70 MHz-120 MHz bandwidth, 1GSa/s sample rate
- Oscilloscope, 4 1/2 digits multimeter
- Max. 14 bit high-resolution hardware
- Excellent measurement performance: 40M record length, 45000 wfms/s waveform refresh rate, low background noise
- Multiple advanced trigger and bus decoding function
- Built-in 8000mAh large capacity battery, can work continuously for 5 hours
- 8-inch multi-point capacitive touch screen
- Multiple communication interfaces: USB Device&Host (USBTMC supported), LAN, SCPI supported

Built-in Wi-Fi module
Easy operations with your mobile devices

Channel selection, horizontal and vertical control areas and multimeter control area

Common function shortcut keys (including Copy, Default, Autoset, Run/Stop, etc)

DMM mode
(2 channels model only)

8 inch (800 X 600) control area multi-point touchscreen

FRONT AREA

Magnifier view of waveform

8 bits resolution **14 bits resolution**

Max. 4 channels input
SPO3074/SPO3074A
SPO3104/SPO3104A

DIGITAL OSCILLOSCOPE PAD



Multimeter connecting sockets

BNC connectors

TOP AREA

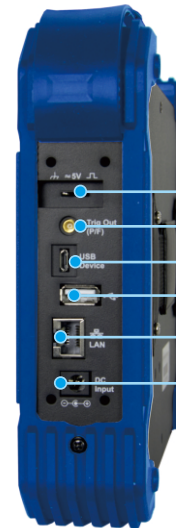

Pass/Fail output connectors

Pass/Fail output connectors

USB Device

USB Host

RJ45 LAN

DC power connector

SIDE AREA

Technical Data	SPO3072 SPO3072A	SPO3102 SPO3102A	SPO3122 SPO3122A	SPO3074 SPO3074A	SPO3104 SPO3104A
Oscilloscope Function					
Channels	2	2	2	4	4
Bandwidth	70MHz	100MHz	120MHz	70MHz	100MHz
Sampling Rate	1GS/s	1GS/s	1GS/s	1GS/s	1GS/s
Vertical resolution (A/D)	8 bits (SPO3072) 14 bits (SPO3072A)	8 bits (SPO3102) 14 bits (SPO3102A)	8 bits (SPO3122) 14 bits (SPO3122A)	8 bits (SPO3074) 14 bits (SPO3074A)	8 bits (SPO3104) 14 bits (SPO3104A)
Record length	40M	40M	40M	40M	40M
Waveform Refresh Rate	45000 wfms/s	45000 wfms/s	45000 wfms/s	45000 wfms/s	45000 wfms/s
Horizontal Scale (s/div)	1 ns/div - 1000s/div, step by 1 - 2 - 5				
Display	8" color LCD, 800 x 600 pixels display, multi-touch screen				
Input Impedance	1MΩ ± 2%, in parallel with 15pF ± 5pF				
Max Input Voltage	1MΩ < 300Vrms				
DC Gain Accuracy	±3%				
Probe Attenuation Factor	0.001 X - 1000X, step by 1 - 2 - 5				
Input Coupling	DC, AC, GND				
Vertical Sensitivity	1 mV/div - 10V/div (at input)				
Trigger Type	Edge, Video, Pulse, Slope, Runt, Windows, Timeout, Nth Edge, Logic, I< SPI, RS232/UART and CAN(optional)				
Bus Decoding (optional)	I ² C, SPI, RS232/UART, CAN				
Trigger Mode	Auto, Normal and Single				
Automatic Measurement	Vpp, Vavg, Vrms, Freq, Period, Week RMS, Cursor RMS, Vmax, Vmin, Vtop, Vbase, Vamp, Overshoot, Phase A→B†, Phase A→B‡ Preshoot, Rise Time, Fall Time, +Width, -Width, +Duty, -Duty, Duty Cycle, Delay A→B† Delay A→B‡, +Pulse Count, -Pulse Count, Rise Edge Count, Fall Edges Count, Area, Cycle Area, FRR, FRF, FFR, FFF, LRR, LRF, LFR, LFF				
Waveform Math	+, -, ×, ÷, FFT, FFTrms, Intg, Diff, Sqrt, User Defined Function, Digital Filter				
Waveform Storage	100 waveforms				
Communication Interface	USB host, USB device, Pass/Fail, LAN and WiFi (optional)				
Frequency Counter	Yes				
Battery	7.4V, 8000mAh, 5 hours operation				
Dimension(WxHxD)mm	270 x 191 x 48				
Device Weight	About 1.7kg				
Multimeter Function (2 channels models only)					
Display	4 1/2 digitals				
Voltage	20.000mV~200.00mV	2.0000VDC~1000.0VDC	2.0000VAC~750.0VAC		
Current	0~20.00A (AC/DC)				
Resistant	200.00Ω~100.00MΩ				
Data logger	Yes (Date export to CSV file)				
Diode	Yes				
Auto Ranging	Yes				

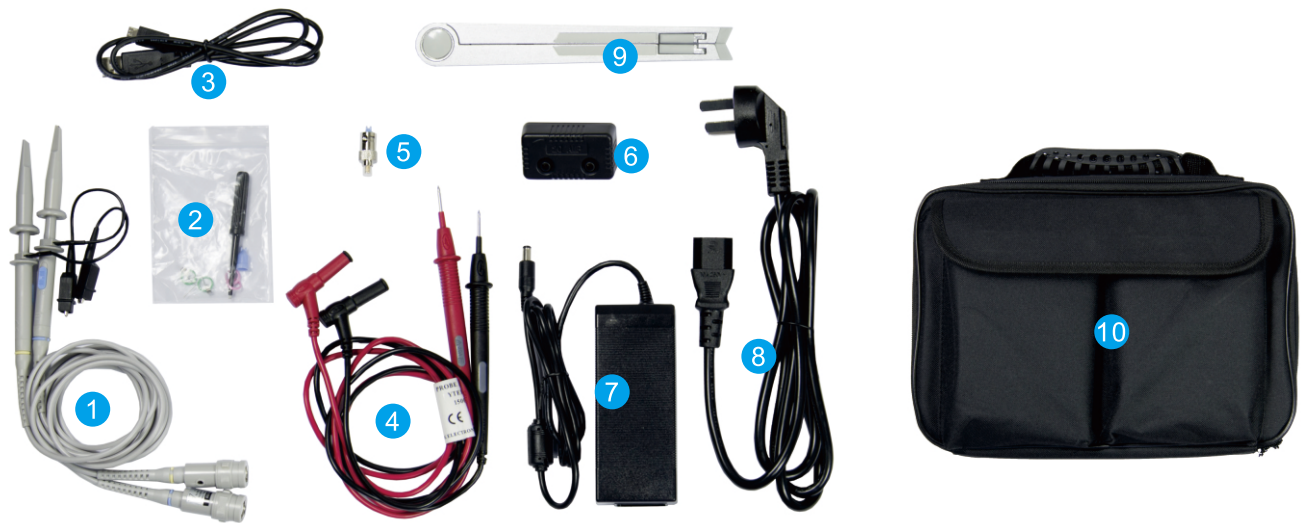

ACCESSORIES

1. Oscilloscope probes X 2
2. Probe adjust accessory
3. Micro USB cable
4. Multimeter leads X 2 (2 channels model only)
5. BNC-SAM
6. Current Ext. module
7. Power adapter
8. Power cord
9. Folding stand
10. Carrying bag



Folding stand